



7 INSTRUCTIONS FOR THE USER

7.1 DESCRIPTION OF THE CONTROL DEVICES

ELECTRONIC CONTROLLER

Ktronic¹⁰

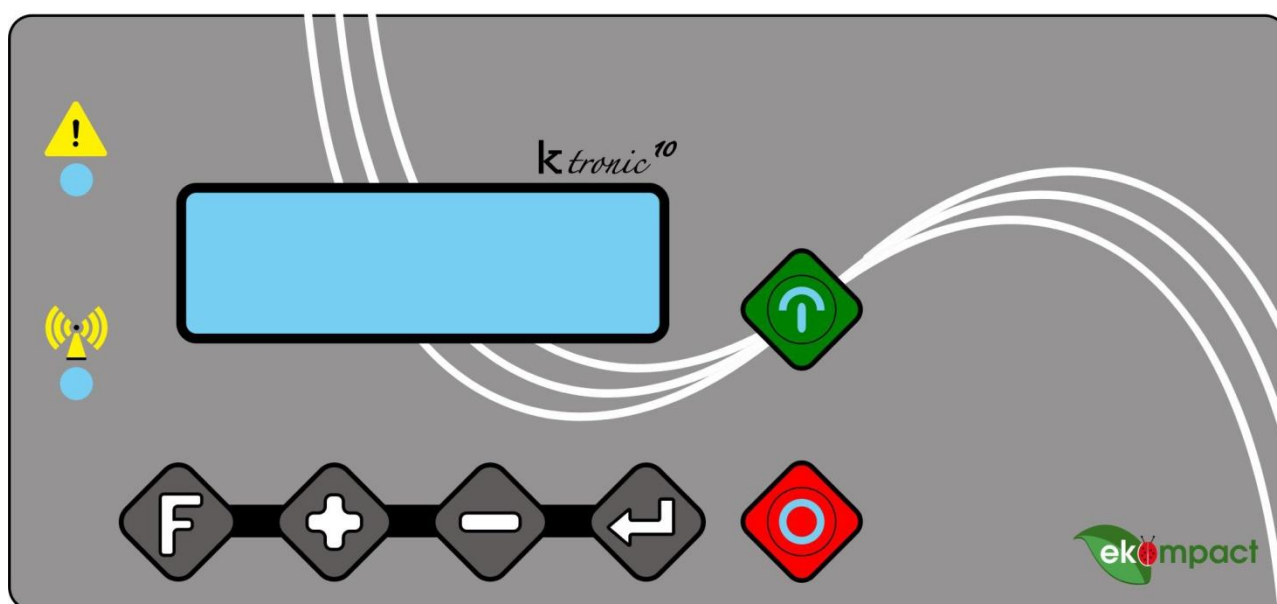

7.1.1 BUTTON LAYOUT



START BUTTON

if there is no active alarm, pressing this button starts the compressor



STOP BUTTON

when pressed, this button stops the compressor after a set period of time



ALARM IN PROGRESS WARNING



REMOTE CONNECTION WARNING

7.2 ALARMS LIST

TYPE OF ALARM	DESCRIPTION
"ALLARME NTC > " "NTC alarm"	Temperature probe failure
"ALTA T. OLIO" "OIL HIGH TEMP.AL"	T. MAX setting exceeded
"BASSA T. OLIO" "OIL LOW TEMP."	T. MIN setting exceeded
"TERMICO COMPRES." "MOTOR TH. SWITCH "	Main motor thermal relay setting exceeded
"TERMICO VENTIL." "FAN TH. SWITCH AL"	Electric fan thermal relay setting exceeded
"ALLARME TRASDUT." "PRESSURE TRD AL."	Transducer failure
"EMERGENZA ATTIVA" "Emergency SWITCH"	Mushroom head emergency stop button pressed
"ANOMALIA FASI" "AC. Phase ERROR"	Phase sequence inverted
"ALLARME SISTEMA!" "SYSTEM ALARM !!!"	General alarm

7.3 DESCRIPTION OF THE OPERATIONS TO BE PERFORMED

MAIN PAGE

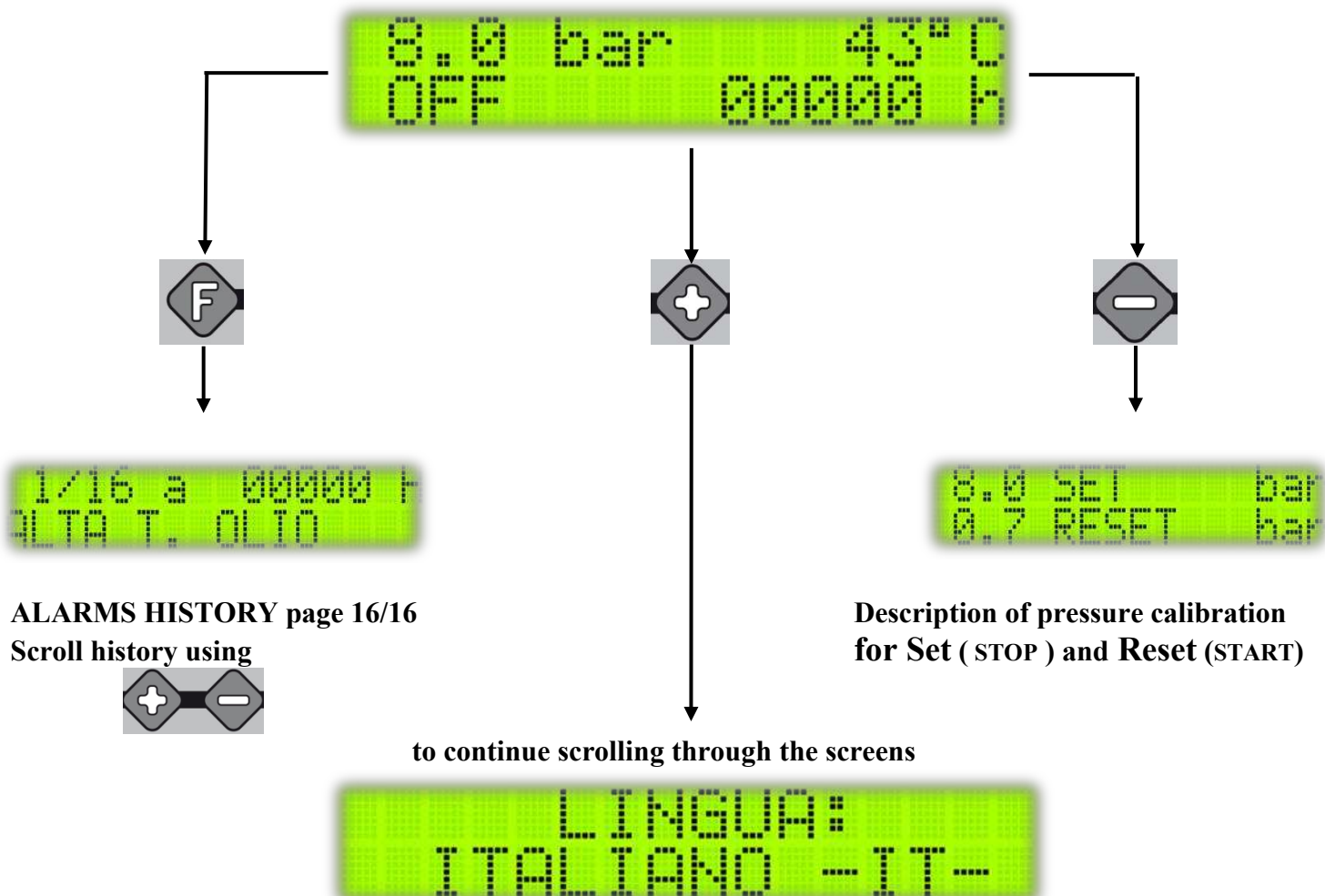
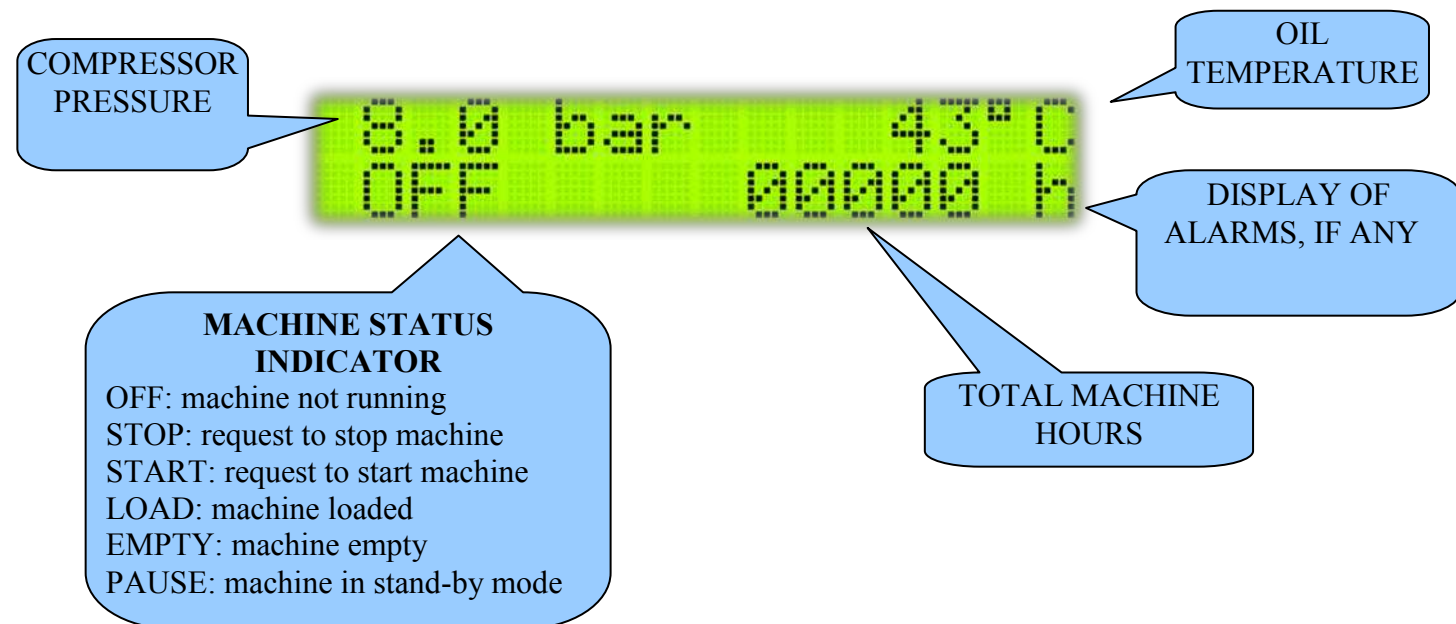

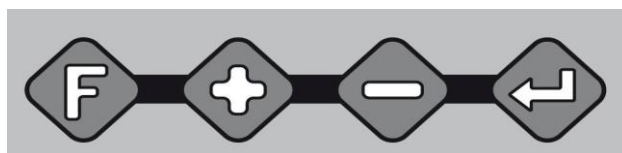

PROGRAMMING KEYPAD

Key:  **MULTIFUNCTION**

- Resets currently saved alarms.
- Switches from main page of the current menu to a subpage.
- In data entry mode, this key selects the setting subfield in maintenance mode and, if kept pressed for 4 sections, cancels and resets the time on the maintenance timer.
- When pressed on any page, after a 5 second delay, it returns to the main menu.

Key:  **ENTER**

- This key activates the data change mode and saves the modifications.
- When in data entry mode, the value to be modified flashes on the screen.
- If the page selected has several fields that can be modified, using  makes it possible to move between fields.

Key: 

- Normally used in data entry mode to change page.
- These keys are used to modify the selected value, keeping them pressed for more than 1 second automatically increases or decreases the value (rapid modification).

7.4 START, STOP AND EMERGENCY STOP FUNCTIONS

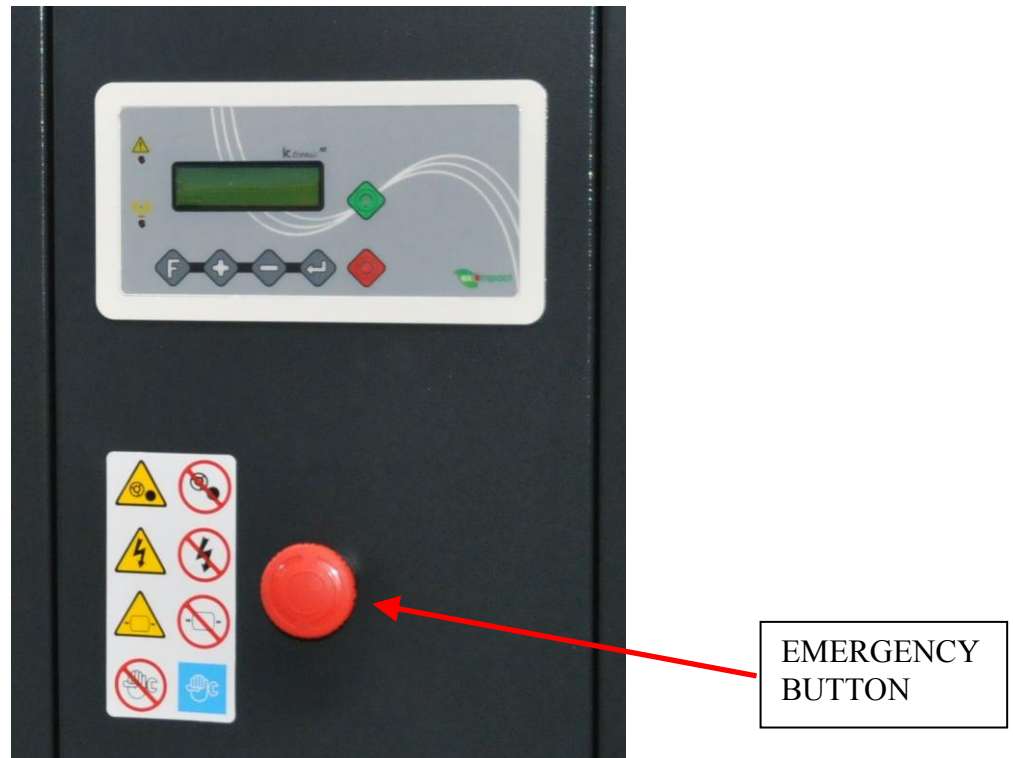

Figure 11

START See chap. 7.1

STOP See chap. 7.1

EMERGENCY STOP

Achieved by pressing the **Emergency button** (see figure).

This mechanically engaged button immediately stops the compressor if an emergency arises. When this button is engaged, the compressor cannot perform any operation.

7.5 RESET CONDITIONS

To reset emergency button functions, turn the button clockwise; this will enable the compressor to start.